

Form No. 42-1409-2 (Internet 7/17)

JUL 18 2025

IN THE DISTRICT COURT OF THE FIFTH JUDICIAL DISTRICT OF THE
STATE OF IDAHO, IN AND FOR THE COUNTY OF TWIN FALLS

IN RE THE GENERAL ADJUDICATION
OF RIGHTS TO THE USE OF WATER FROM
THE SNAKE RIVER BASIN WATER SYSTEM

CIVIL CASE NUMBER: 39576 Deputy Clerk

Claim ID: 61-12378

Date Received: _____

Receipt No: _____

Claim Fee: _____ By: _____

NOTICE OF CLAIM TO A WATER RIGHT
ACQUIRED UNDER STATE LAW
For Domestic and/or Stockwater Purposes
Where Daily Use is less than 13,000 gallons per day

Please type or print clearly

- Name of claimant(s) Casa Del Norte, LP Phone (208) 599-1580
Mailing address 11204 N. Bar Dr. Glenns Ferry Idaho Zip 83623
Street or Box City State
Email address (optional) irondragonmistress@yahoo.com
- Date of priority: (Only one per claim) 4/20/1877 (Explain priority date selected in Remarks)
Month/Day/Year (YYYY)
- Source of water supply (Check one) Ground Water () or Other (✓) (a) Bennett Creek
which is tributary to (b) Snake River
- Location of point of diversion is: Township 05S, Range 08E, Section 03,
_____ 1/4 of _____ 1/4, or Govt. Lot _____ BM, County of Elmore;
Parcel no. _____
Additional points of diversion, if any: See Supplemental Sheet
If available, GPS coordinates: _____
- Description of diverting works (wells, pumps, spring boxes, pipelines, etc.) including the dates of any changes or enlargements in use, the dimensions of the diversion works as constructed and as enlarged and the depth of each well.
Instream stockwater on BLM property within the Hammett #3 Allotment (ID01035)
through Grazing Permit 1101651.
- Water is claimed for the following: (limited to domestic and/or stockwater uses - see page 1 of the instructions)
For Instream Stockwater purposes from 01/01 to 12/31 amount .02 cfs (✓) or AFY ()
For _____ purposes from _____ to _____ amount _____
- Total quantity claimed .02 cfs (✓) or AFY ()
- Non-irrigation uses. Describe fully. (Domestic: give number of homes; Stockwater: list number and kind)
Historic vested right to 800 C and 75 H, converted to 894 C distributed on all BLM and CDN, LP sources

9. Location of place of use is: Township 05S, Range 08E, Section 03,
1/4 of 1/4, Govt. Lot BM, Parcel no. If different than shown in Item 4
for (check one) **Domestic** () **Stock** (✓) **Domestic and Stock** ()

Additional places of use, if any See Supplemental Sheet

10. In which county(ies) are lands listed above as place of use located? Elmore

11. Do you own the property listed above as place of use? Yes () No (✓)

If the answer is No, describe in Remarks below the authority you have to claim this water right.

12. Describe any other water rights used at the same place and for the same purposes as described above.

USDI BLM 61-11459 with a priority date of 06/28/1934 or None ()

13. Remarks (include an explanation of the priority date selected):

~~Vested rights rights, as recognized by Congress in the Mining Act of March 6, 1866, 14 Stat. 253, Sec. 9,~~
evidenced by an exhaustive chain of title on original appropriator.

14. Basis of claim (check one) **Beneficial Use** (✓) **Posted Notice** () **License** () **Permit** () **Decree** ()

Court _____ Decree Date _____ Plaintiff v. Defendant _____

If applicable provide IDWR Water Right Number _____

15. **Signature(s)**

(a.) By signing below, I/We acknowledge that I/We have received, read and understand the form entitled "How You Will Receive Notice in the Snake River Basin Adjudication."

(b.) I/We do () do not () wish to receive and pay a small annual fee for monthly copies of the docket sheet.

Number of attachments: _____

For Individuals: I/We do solemnly swear or affirm under penalty of perjury that the statements contained in the foregoing document are true and correct.

Signature of Claimant(s) _____ Date: _____
_____ Date: _____

For Organizations: I do solemnly swear or affirm under penalty of perjury that I am, and that I have signed the foregoing document in the space below as the

Managing Member of Casa Del Norte, LP,
Agent's title (Please print) Name of organization (Please print)

and that the statements contained in the foregoing document are true and correct.

Signature of Authorized Agent Teresa M. McCallum Date 7/15/25

Printed Name of Authorized Agent Teresa M. McCallum

16. **Notice of Appearance:**

Notice is hereby given that I, (please print) _____, will be acting as attorney at law of behalf on the claimant signing above, and that all notices required by law to be mailed by the director to the claimant signing above should be mailed to me at the address listed below.

Signature _____ Date _____

Address _____

Name of claimant(s) _____ Claim ID _____

STATE OF IDAHO
DEPARTMENT OF WATER RESOURCES

Ident. No. _____

Point of Diversion/Place of Use Supplement

Clear Form

Attachment to: ☐ Application for Permit to Appropriate Water ☐ Application for Transfer** ☒ Adjudication Claim
☐ Application for Amendment of Permit ☐ Beneficial Use Field Report ☐ Statutory Claim

Location of points of diversion (POD):

New POD?	Twp	Rge	Sec	Govt Lot	1/4	1/4	1/4	County	Source	Local name or well/diversion tag #
<input checked="" type="checkbox"/> Yes	05S	08E	03			SW	NE	Elmore	Bennett Creek Beginning	
<input checked="" type="checkbox"/> Yes	05S	08E	03			SE	SE	Elmore	Bennett Creek End	
<input type="checkbox"/> Yes										
<input type="checkbox"/> Yes										
<input type="checkbox"/> Yes										
<input type="checkbox"/> Yes										
<input type="checkbox"/> Yes										
<input type="checkbox"/> Yes										
<input type="checkbox"/> Yes										
<input type="checkbox"/> Yes										

Description of place of use (POU):



- a. If water is for irrigation, indicate acreage in each subdivision in the tabulation below.
b. If water is used for other purposes, place a symbol of the use (example: D for Domestic) in the corresponding place of use below.

TWP	RGE	SEC	NE				NW				SW				SE				TOTALS
			NE	NW	SW	SE	NE	NW	SW	SE	NE	NW	SW	SE	NE	NW	SW	SE	
05S	08E	03			S	S									S			S	

61-12378



3/31/2025, 11:19:57 AM

-  Quarter Quarters
-  PLS Sections
-  Townships

-  POD
-  POU

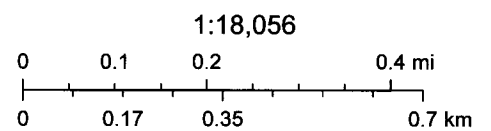

Esri, HERE, IPC, Esri, HERE, Garmin, IPC, Maxar

State of Idaho
Department of Water Resources

Water Right

61-11459

STOCKWATER

The map depicts the place of use for the water use listed above and point(s) of diversion of this right as currently derived from interpretations of the paper records and is used solely for illustrative purposes. Discrepancies between the computer representation and the permanent document file will be resolved in favor of the actual water right documents in the water right file.

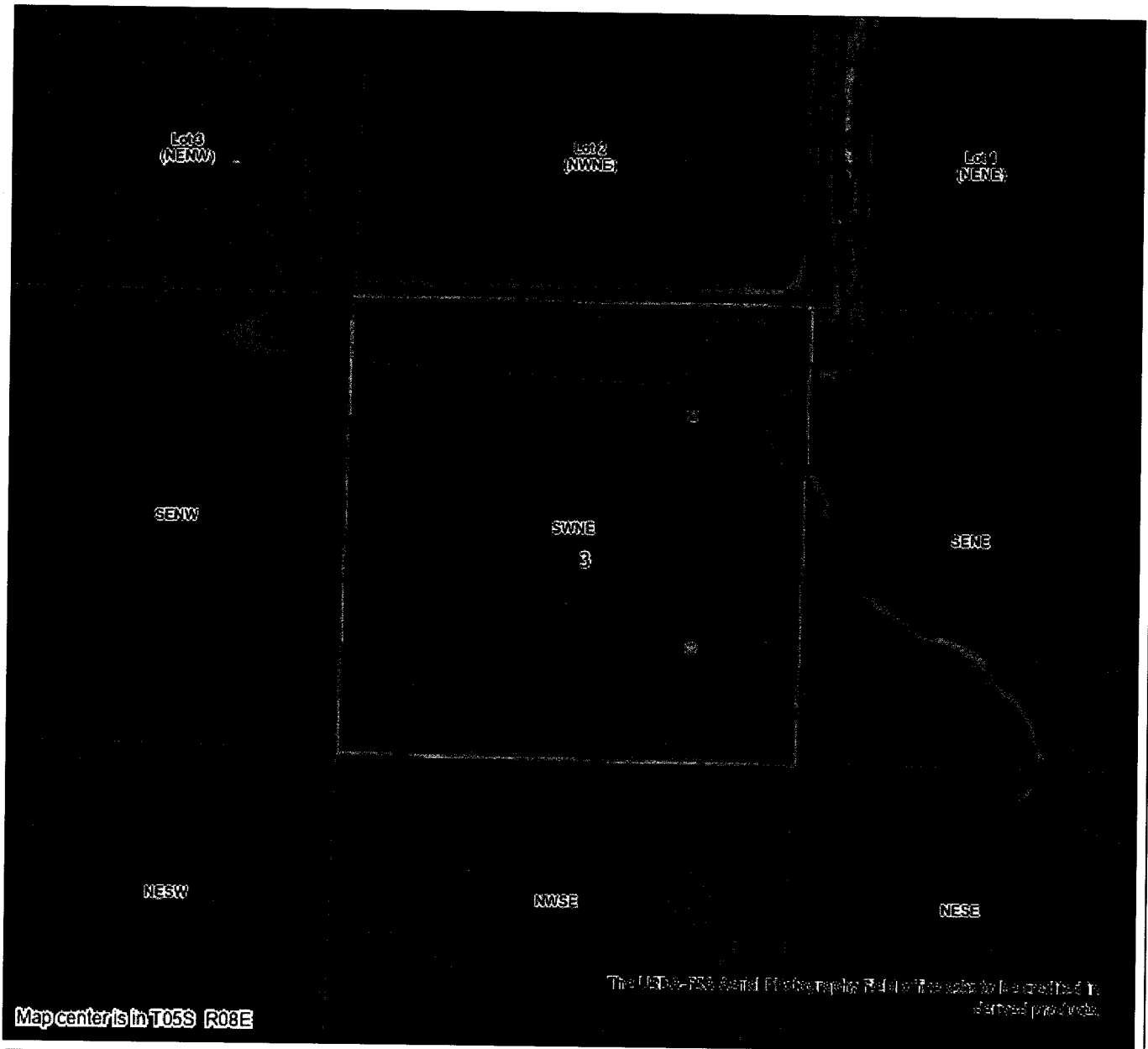

Date created: 3/16/2025



Legend

- Quarter Quarters
- PLS Sections
- Townships
- Place of Use Boundary
- Point of Diversion

